

15" Marvel High Efficiency Single Zone Wine Cellar

Model # ML15WS****

- Dynamic Cooling Technology™ delivers rapid cooldown and the industry's best temperature stability
- MARVEL Intuit™ Integrated Controls provide precise temperature management from 40°F to 65°F
- Vibration Neutralization System™ protects wine from agitation
- Two-stage, soft white theatre-style LED lighting and midnight black interior
- Thermal-efficient cabinet ensures optimum food preservation and energy efficiency while maximizing capacity
- Tinted, UV-resistant dual pane glass door protects wine from damaging ultra-violet light
- Natural maple shelf fronts are stainable to match cabinetry
- Three-quarter extension roller-glide shelf system prevents jarring
- Close Door Assist System™ gently and automatically closes door
- Panel overlay option features soft-close integrated hinge for a truly flush fit with cabinetry
- Audible and visual alarms signal when door is left ajar to protect wine integrity and energy use
- Vacation/Sabbath mode conserves energy during times when the unit is not in use
- Sleek stainless steel door and designer handle
- Height adjustment up to 1" with leveling legs
- Filler kit available for 18" wide opening, see page 58
- Up to 2x more efficient than leading competitors
- 4" black adjustable toe kick
- 1-year warranty



Ordering Details	
Stainless Frame Glass Door, Right Hinge	ML15WSG1RS
Stainless Frame Glass Door, Left Hinge	ML15WSG1LS
Smooth Black Frame Glass Door, Right Hinge	ML15WSG1RB
Smooth Black Frame Glass Door, Left Hinge	ML15WSG1LB
Panel Overlay Frame Glass Door, Integrated Right Hinge	ML15WSF2RP
Panel Overlay Frame Glass Door, Integrated Left Hinge	ML15WSF2LP
Solid Panel Overlay Ready Door, Integrated Right Hinge	ML15WSP2RP
Solid Panel Overlay Ready Door, Integrated Left Hinge	ML15WSP2LP

No panel installation kit required.

Storage Capacity

Up to 24 bottles total

Storage Configuration

(6) 4-bottle roller-glide wine racks

Product Dimensions

14⁷/₈" W x 33³/₄" minimum H x 25⁵/₈" D (including handle)

Finish/Door Options

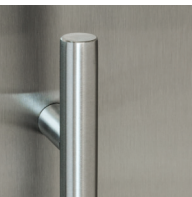

Stainless Steel



Black



Wood Overlay
(Panel Ready)

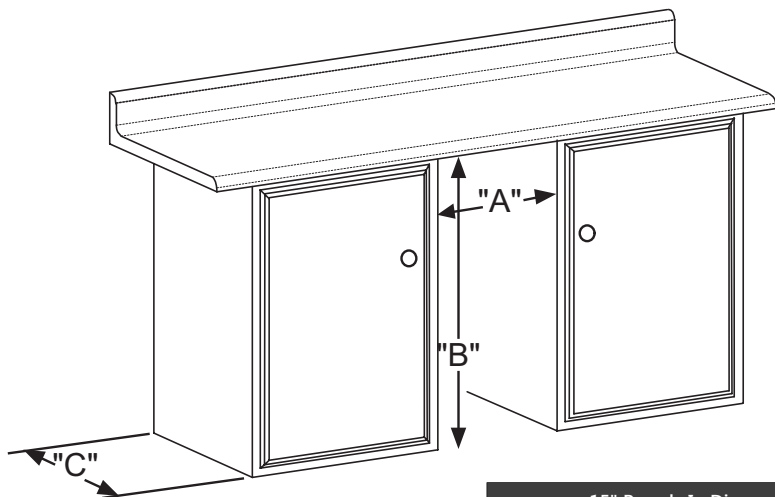

15" Rough-In Dimensions		
"A"	"B"	"C"
15" (38.1 cm)	**34" to 35" (86.4 to 88.9 cm)	24" (61 cm)

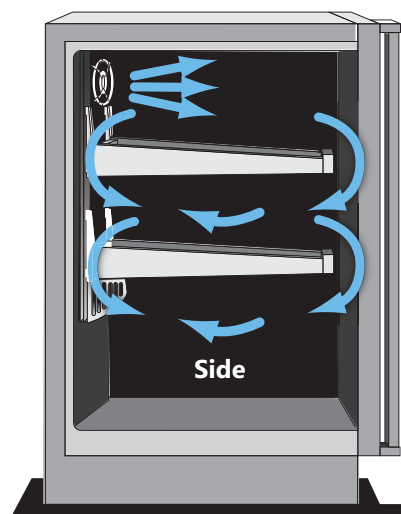
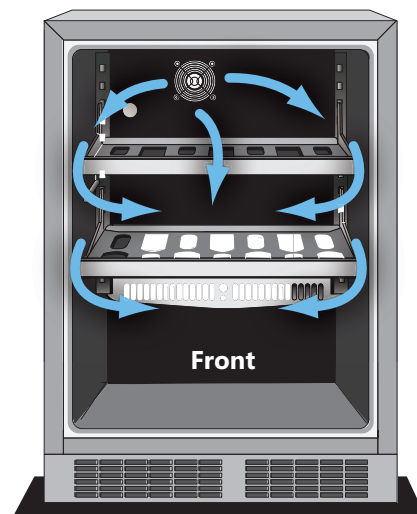

Cabinet Dimensions		
"D"	"E"	"F"
14 7/8" (60.7 cm)	33 3/4" to 34 3/4" (85.7 to 88.3 cm)	23 23/32" (60.2 cm)
"G"	"H"	"J"
25 21/32" (65.2 cm)	37 13/32" (95 cm)	16 11/16" (42.4 cm)

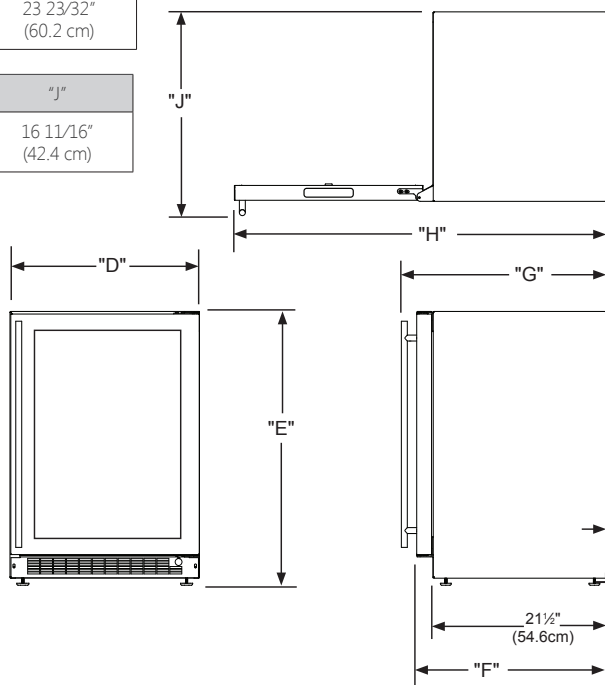

Dynamic Cooling Technology™ delivers rapid cool down and the industry's best temperature stability

The distinctive Marvel design features a thermal-efficient cabinet and door combined with Dynamic Cooling Technology™ for superior temperature stability, faster cooling times and speedy temperature recovery even with high frequency.

Width	14 7/8"
Interior Finish	Black
Capacity	Up to 24 wine bottles
Shelving System	Side mount - tray
Shelf Fronts	Black painted maple
Other Storage	NA
Interior Lighting	2 White LED Pods
Toe Grill Finish	Black
Hinge	Classic Hinge
Handle	Designer

Control Type	Intuit™
Temperature Range	40° - 65° F
Lock	NA
Electrical Requirements	120V / 60Hz / 15A
Length of Power Cord	5'
Product Dimensions	14 7/8" W x 33 3/4" H x 21 1/2" D
Depth to Front of Door	23 23/32"
Depth to Handle	26 1/4"
Depth with door at 90°	37 1/16"
Shipping Weight	125 lbs

Finishes	SS, B, O
Vacation / Sabbath Mode	Yes
Agency Approvals	CSA
ENERGY STAR Certified	NA

Finishes Key

SS = Stainless Steel
B = Black
O = Overlay

Overlay Panels

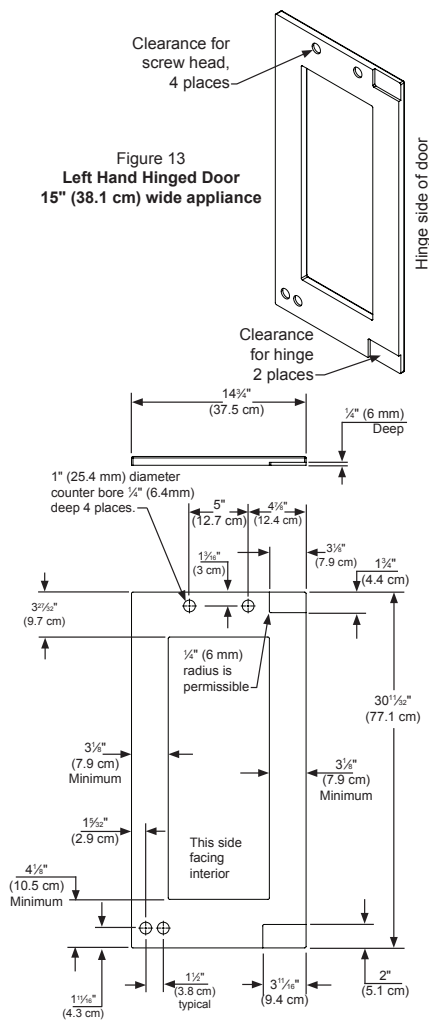

Figure 14
Left Hand Hinged Door
15" (38.1 cm) Wide Appliance

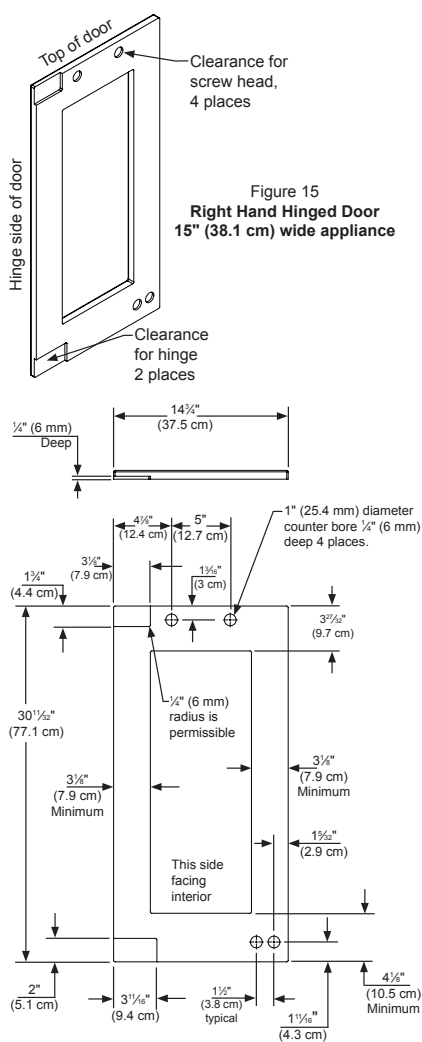

Figure 16
Right Hand Hinged Door
15" (38.1 cm) Wide Appliance

The preferred method of attaching the panel to the door is to clamp the panel to the door so it cannot move while drilling the screw pilot holes. Use bar clamps or "C" clamps with pads on the clamping surfaces that will not mar the panel or the door. The custom overlay panel should be flush with the top of the door and centered along the width of the door. See Figure 12a. Drill holes through the gasket extrusion using the 10 holes as pilot holes. Use the drill size from the chart in Table "C", being careful not to drill through the front surface of the panel, drill no deeper than 1/2" (12.7 mm) deep. If the overlay panel is thinner than 3/8" (16 mm) thick shorter screws will have to be obtained. Fasten the panel to the door with the 10 screws provided in the literature pack. (See Figure 21). Remove the clamps and replace the gasket in the gasket extrusion channels of the door. Some force may be required to seat the gasket into the channels. Be sure the gasket corners are seated properly.

Material Type	#10 Wood Screw
Hardwood	5/8" (3.2 mm) Diameter. Pilot Hole
Softwood	7/64" (2.8 mm) Diameter. Pilot Hole

Table C

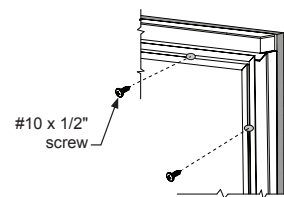
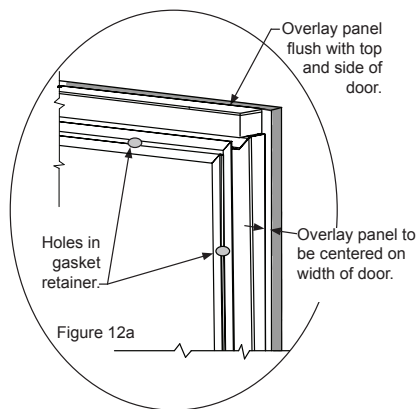

Figure 21